

# gMax 2 SSR

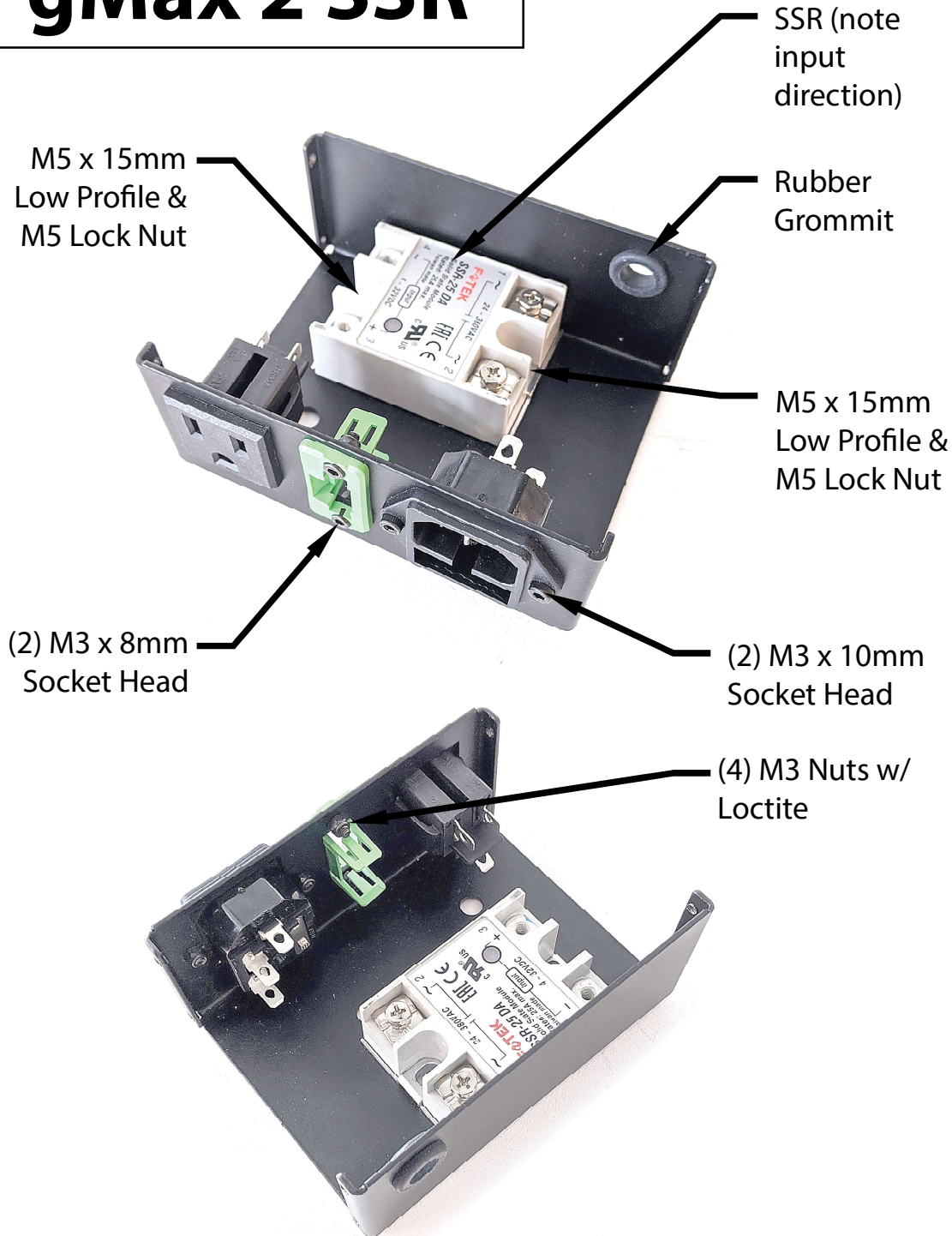

## Parts Needed

- (2) M3x6 mm Socket Head
- (2) M3x8 mm Socket Head
- (4) M3 Nuts
- (2) M5x15 mm Low Profile Socket head
- (2) M5 Lock Nut
- (1) Metal Case
- (1) SSR
- (1) Rubber Grommet
- (1) Male Socket
- (1) Female Socket
- (1) 2 Pin Green Connector

## Steps

1. Tap (8) side holes with M3 tap
2. Install power sockets with M3 screws. Secure with M3 nut and loctite.
3. Install SSR with M5 x 15 flat head and include ground wire with insulated eye connector

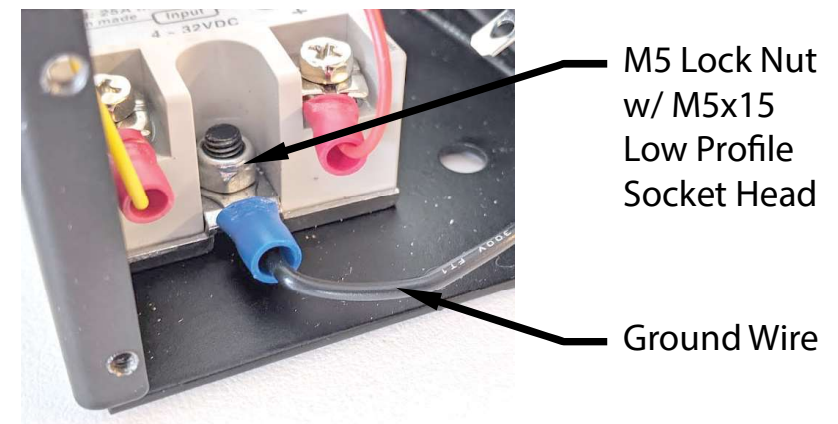

## Parts Needed

(2) Wire Set From Wiring Diagram

## Steps

1. Connect black ground wire first. Route under power sockets from relay to wall plug power receptacle
2. Install Green/Blue thermistor wire.
3. Install red wire to terminal #3 and install yellow wire to terminal #4
4. Install short black wire terminal #2 to wall plug power receptacle
5. Connect long red wire from terminal #1 to heated bed plug receptacle
6. Connect short red wire from heat bed power receptacle to wall plug power receptacle
7. Add hot glue to sides of heated bed power receptacle
8. Install cover with (8) M3x6mm Socket Head

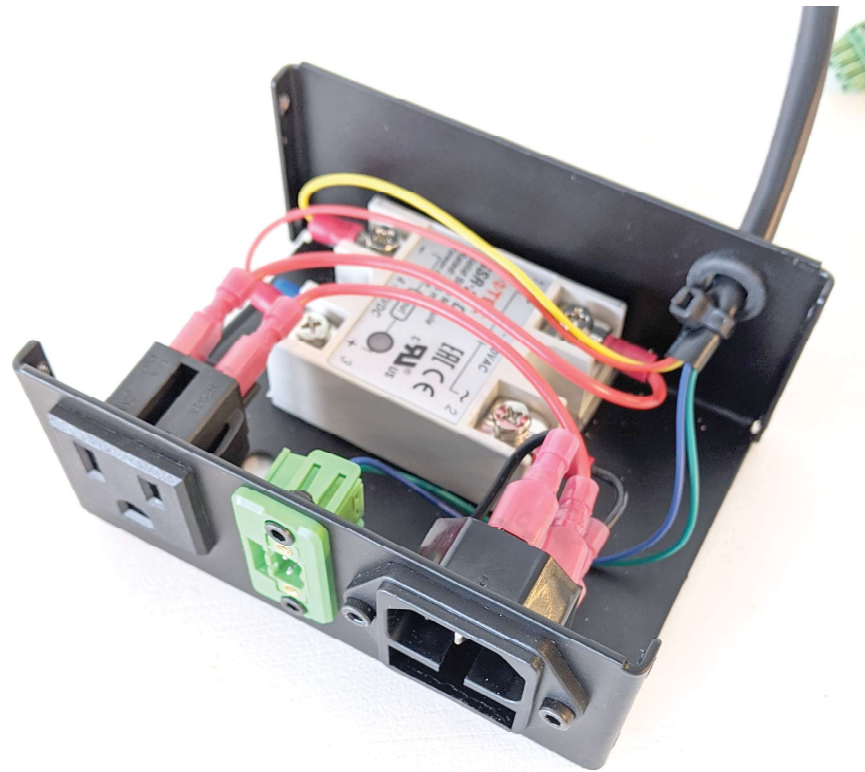

Insert printed clips

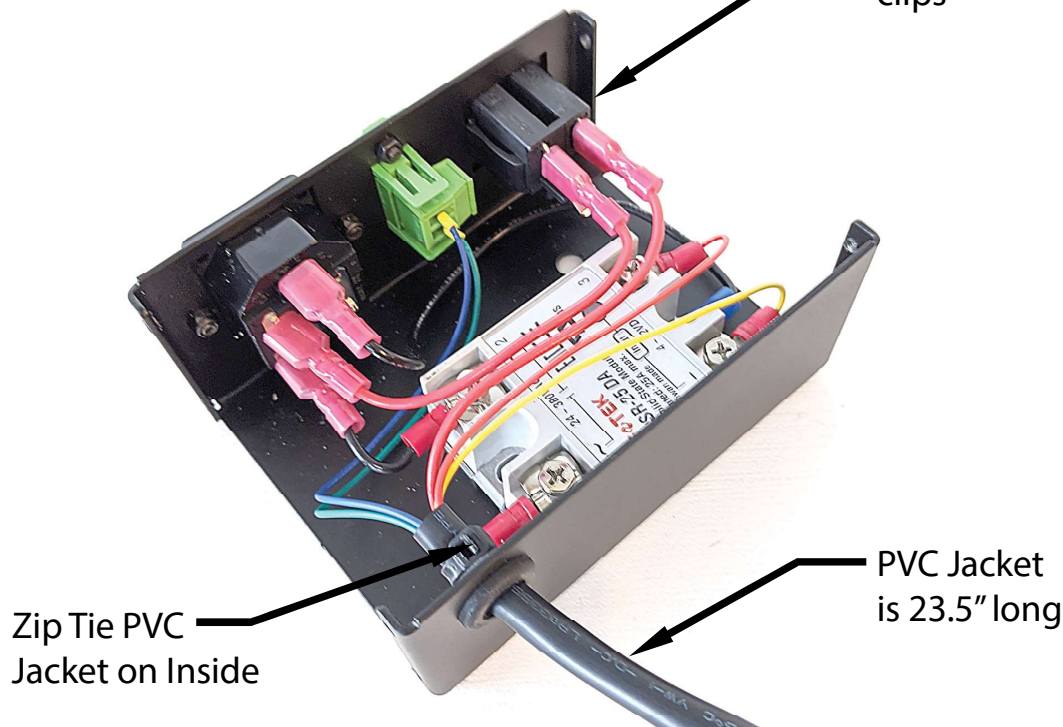

Zip Tie PVC Jacket on Inside

PVC Jacket is 23.5" long